

ITEM NO.	PART NUMBER	DESCRIPTION	MATERIAL	DRAWING #	QTY.
1	FL 25 X 3 L 3	LENGTH: 3"	FL 1/4" x 3"	STOCK	1
2	FP-FL9550-4	FLARE SHEET, PASS, FL9550	7ga HRS.	90-2209	1
3	FP-FL9555-2	L-BRACKET, REAR, FL9555	1/4" HRS	90-2218	2

REV.	REVISIONS DESCRIPTION	DATE	APPROVED
B	UPDATED TO MATCH 3D MODEL	12/29/2011	
C	ADDED FP-FL9555-2 FOR FP-FL9250-1,2, & FP-FL9550-1,2 & REMOVED 3 FL-1/4x1-1/4xL 2	9/14/2012	

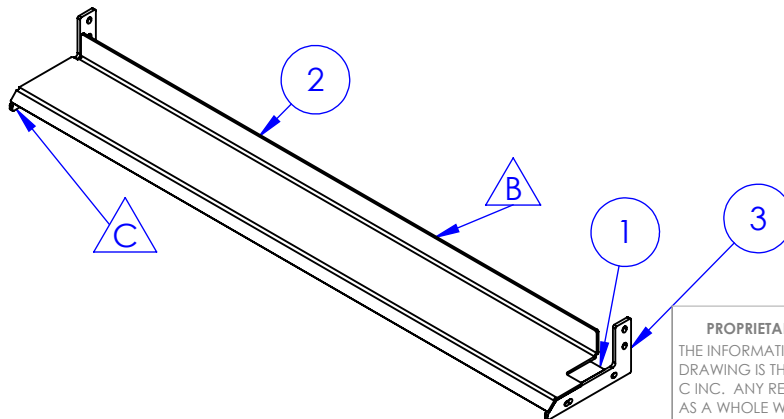
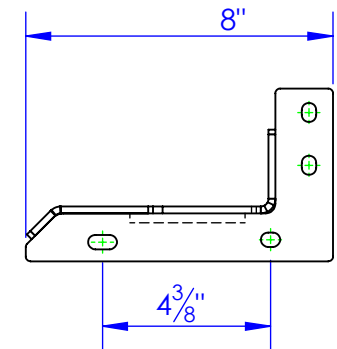
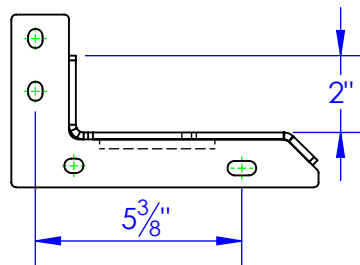
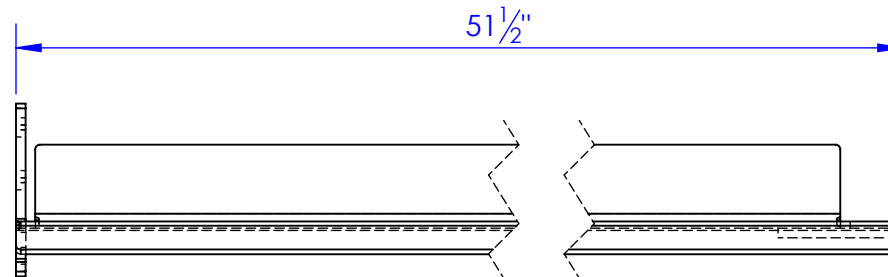
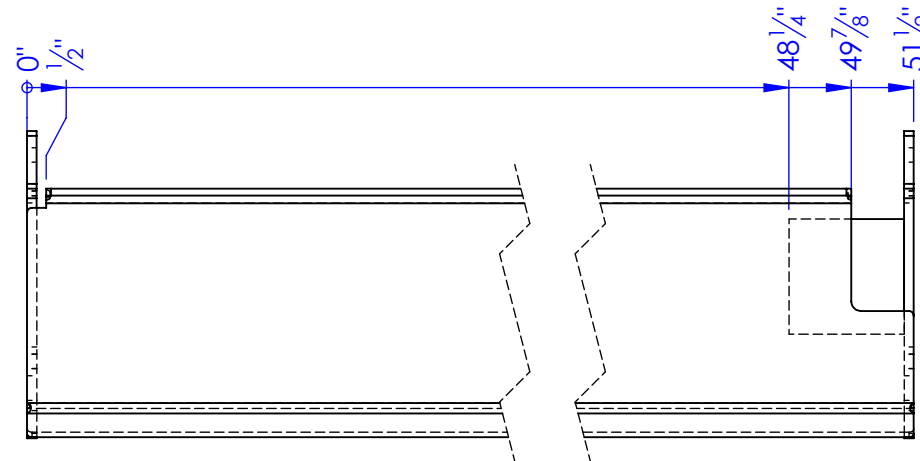

**PROPRIETARY AND CONFIDENTIAL**  
THE INFORMATION CONTAINED IN THIS DRAWING IS THE SOLE PROPERTY OF TRIPLE C INC. ANY REPRODUCTION IN PART OR AS A WHOLE WITHOUT THE WRITTEN PERMISSION OF TRIPLE C INC. IS PROHIBITED.

DIMENSIONS ARE IN INCHES  
TOLERANCES:  
FRACTIONAL  $\pm 1/16$   
ANGULAR: MACH  $\pm 1$  BEND  $\pm$   
TWO PLACE DECIMAL  $\pm 0.10$   
THREE PLACE DECIMAL  $\pm 0.005$

MATERIAL ---

DO NOT SCALE DRAWING

NAME	DATE
DRAWN HEATH	9/14/2012
PART #	
ASM #	FP-FL9550-6

COMMENTS:

FENDER FLARE,  
PASSENGER FL955,  
WLDMT.

P.O. BOX 248,  
SABETHA, KS 66534

**TRIPLE C**  
INC.

SIZE A	DWG. NO. 90-1203 C	REV. C
SCALE: 1:5	WEIGHT: 24.54 LBS.	SHEET 1 OF 1